

OUR SUPPORTERS

A MESSAGE FROM THE VICAR OF BIGGLESWADE Revd. William Thackray

I am thrilled at the prospect of adding an extension to the Chapter House as well as carrying out various improvements and refurbishments to the existing facilities.

Our intention in embarking on this very ambitious and challenging project is broader than extending a church hall. We are always wanting to be seen as a "community church" and we regard an enhanced and enlarged Chapter House as a clear sign of our commitment to this growing town of Biggleswade and the needs of its community – young and not so young, church members and otherwise. We are doing this for *everyone* and not just for ourselves.

We are asking for your backing, your generous and active support and your prayers.

William Thackray

PATRONS of the APPEAL

Mr Samuel Whitbread, Lord Lieutenant of Bedfordshire

Mr Alistair Burt MP, MP for North East Bedfordshire

Cllr Peter Vickers, Mayor of Biggleswade

The Rt Rev Richard Inwood, Bishop of Bedford

The Ven Paul Hughes, Archdeacon of Bedford

The Revd Canon Peter Hill, former Vicar of Biggleswade

Mrs Sue Rolfe, Head Teacher,
St Andrew's Lower School, Biggleswade

Mr Chris Garraway, Head Teacher,
Edward Peake Middle School, Biggleswade

HOW YOU CAN HELP

Naturally we welcome gifts in the form of donations as well as pledges of regular monthly giving. If you are able to help please complete the form below and return it to the Appeal Treasurer.

You will also be very welcome at any of our fund raising events, details of which are published on the church website and in the church magazine and weekly notices.

I enclose a donation to the appeal of: (Cheques payable to "CHDA" please) £
Name: *
Address: *
Postcode: * * Required for Gift Aid
<input type="checkbox"/> I am a UK taxpayer. Please Gift Aid this donation. <i>giftaid it</i>
<input type="checkbox"/> I would like to set up a regular monthly payment to the Appeal. Please contact me.
Telephone:

CONTACT DETAILS

Enquiries:
Mr Kevin Goody
28 Bluebell Close
Biggleswade
Beds
SG18 8SL

Donations to:
Mr George Dilley
33 Beech Avenue
Biggleswade
Beds
SG18 0EG

Email: chda@biggleswadeparishchurch.co.uk
Website: www.biggleswadeparishchurch.co.uk

St Andrew's Church Biggleswade CHAPTER HOUSE DEVELOPMENT APPEAL



**OUR EXISTING ROOMS ARE USED
BY MANY COMMUNITY AND
CHURCH GROUPS - BENEFITING
YOUNG AND OLD**



**BUT NOW THE ROOMS ARE
ALMOST FULL - WE NEED MORE
SPACE, A BIGGER KITCHEN, AND
IMPROVED TOILET FACILITIES
WITH EASIER ACCESS FOR ALL**

**AND WE NEED
YOUR HELP TO DO IT**

BUILDING FOR THE FUTURE

BUILDING FOR THE FUTURE

OUR VISION

St. Andrew's Church lies at the heart of the rapidly growing market town of Biggleswade where it offers the community a historic and beautiful place of worship. Week by week many church and community groups use the adjoining Chapter House and Ivel Room, which are close to the town centre and offer easy access and pleasant surroundings.

The vision at St. Andrew's is that the church should continue to provide a real welcome to all, but increasingly we are finding that the meeting rooms are fully booked - we are running out of space! However, by extending the existing building we can add extra meeting room space, extend the kitchen, and provide improved toilet facilities that will offer easier access for everyone. The building will then continue to be a great asset for the church and the local community.

OUR APPEAL

The Church Council have now launched an appeal to raise £250,000 in two and a half years. We hope to raise a significant part of the funding from grants, but more than half will need to be raised through public subscription and a programme of fund raising activities and events.

We are therefore inviting individuals, groups and businesses from the church and the local community to support the appeal as generously as they can. We believe that this really is a project that will continue to benefit groups and organisations in the local community.

OUR PLANS

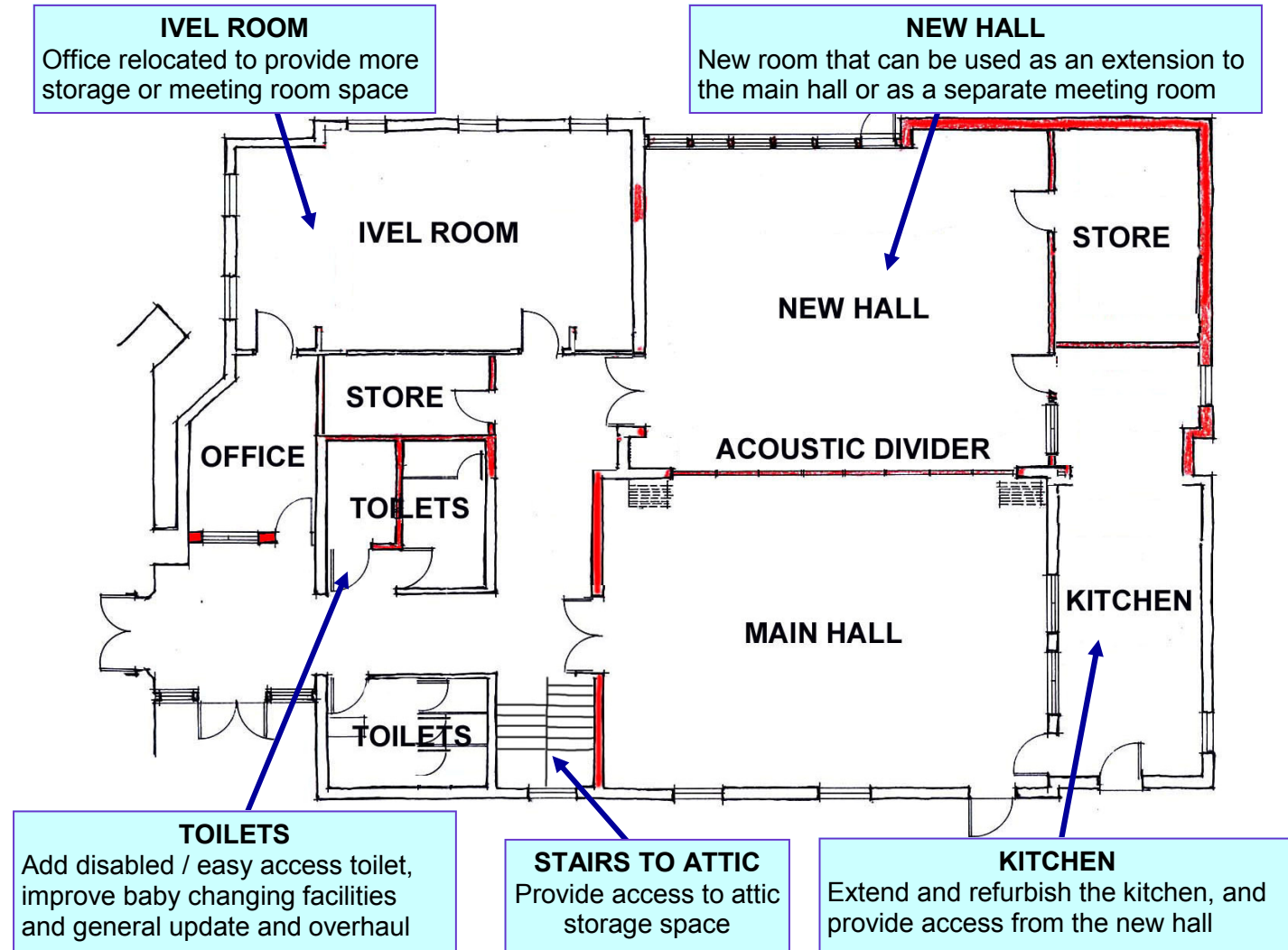

Please note that at the time of writing these plans are still subject to final detailed design and approval.